

# APN-P·S 215 (Twin Head)

No. 91-025  
Mar. 01, 2006

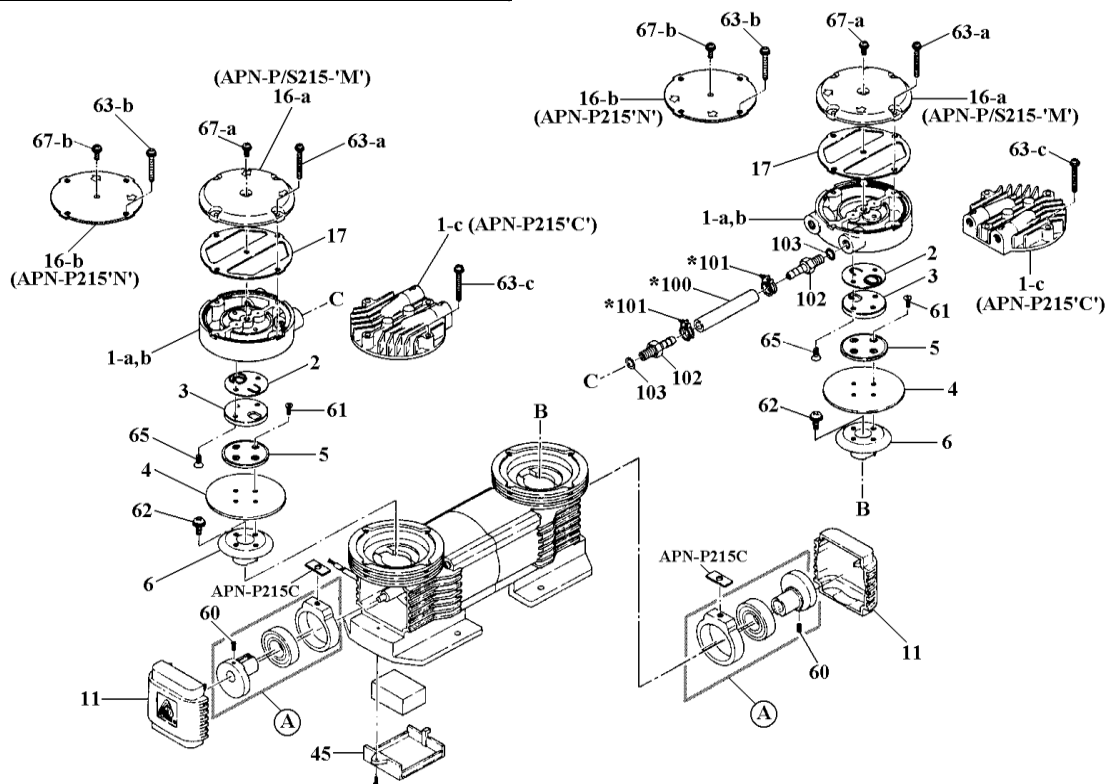

Item	Description	Remark	Q'ty	APN-P·S215'M'	APN-P215'N'	APN-P215'C'	
				Part No.	Part No.	Part No.	
1-	<b>Pump Head</b>		2	AP0290	AP0345	AP0353	
a,b/c	Hose (Ø 9mm) & G1/8"	Material →		GFRPP	GFRPA	ADC12	
2	Valve	V	FKM	2	AP0291	↔	↔
		E	EPDM	2	AP0292	↔	↔
3	Valve Seat		2	AP0346	↔	↔	
4	Diaphragm	V	FKM	2	AP0294	↔	↔
		E	EPDM	2	AP0295	↔	↔
5	Retainer Plate		2	AP0347	↔	↔	
6	Connecting Rod A		2	AP0297	↔	↔	
11	Bracket Cover		2	AP0300	↔	↔	
16-	<b>Pump Head Cover</b>		2	AP0302	AP0348		
a/b		Material →		GFRPP	SUS304		
17	Seal Gasket	V	FKM	2	AP0303	↔	
		E	EPDM	2	AP0304	↔	
45	Capacitor Cover		1	AP0531	↔	↔	
60	Setscrew (Steel)		4	AP0308	↔	↔	
61	Screw (SUS304 equivalent)		8	AP0503	↔	↔	
62	Screw+Washer (Steel)		2	AP0309	↔	↔	
63-	Screw+Washer (S4 equiv.)		8	AP0412	AP0409	AP0354	
		Size →		M5x45	M5x40	M5x30	
65	Screw (SUS304 equivalent)		4	AP0504	↔	AP0505	
		Size →		M5x12	↔	M5x10	
67-	Screw+Washer (S4 equiv.)		2	AP0413	AP0352		
a/b		Size →		M5x18	M5x12		
*100	Hose	'S' only	1	AP0522			
*101	Hose Band	'S' only	2	AP0316			
102	Fitting		4	AP0518	↔	↔	
103	O-Ring, P-8	V	FKM	4	AP0028	↔	↔
		E	EPDM	4	AP0312	↔	↔
A	Connecting Rod B Unit		2	AP0519	AP0521	↔	

Note: Items marked with \* are for APN-"S"215M type only.

⚠ Subject to change without prior notice! ⚠ Actual pump may differ from the exploded view!