



The Heart of Industry

IWAKI

IWAKI
MAGNETIC
DRIVE
PUMPS

MDM

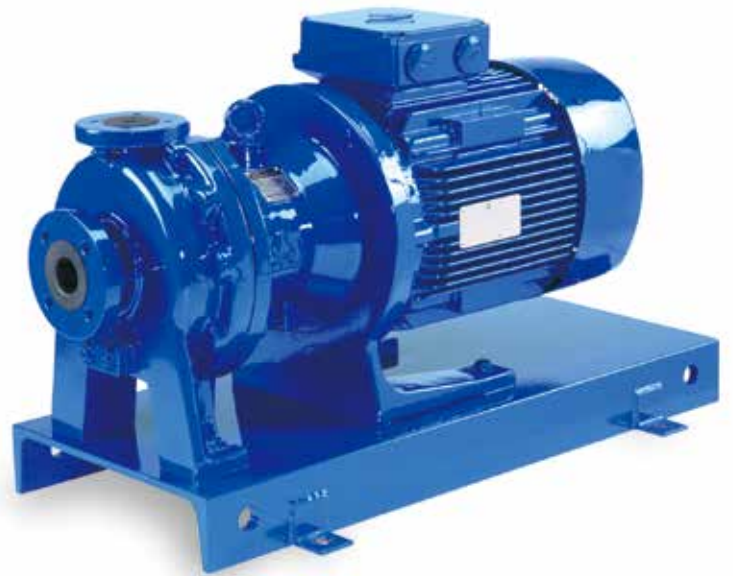

Patent

JAPAN / U.S.A. / TAIWAN / EU / CHINA

Solutions for chemical handling applications

Magnetic drive process pump resistant to dry run damage

The MDM Series of Magnetic drive process pumps have wetted parts made of fluororesin. Natural PFA and CFRETFE being standard materials of construction. The MDM features a unique mechanism which gives a greatly improved performance against dry running (Non contact system). Applications cover a wide range of chemical process duties from acid to alkali together with high purity chemicals for the semiconductor industry.

Unique design prevents dry running

(Non contact system) (PAT.)

The pump design features a mechanism to withstand dry running. High magnet power of the rare earth magnets prevents the magnet capsule coming into contact with the thrust ring of the rear casing, thus preventing melting of fluororesin components due to heat generation. This greatly improves resistance against dry running in comparison with conventional magnetic drive pumps made of fluororesin.

Note: Only CF type (fitted with high density carbon bearing) can cope with dry running. Dry running is not permitted in the case of KK type.

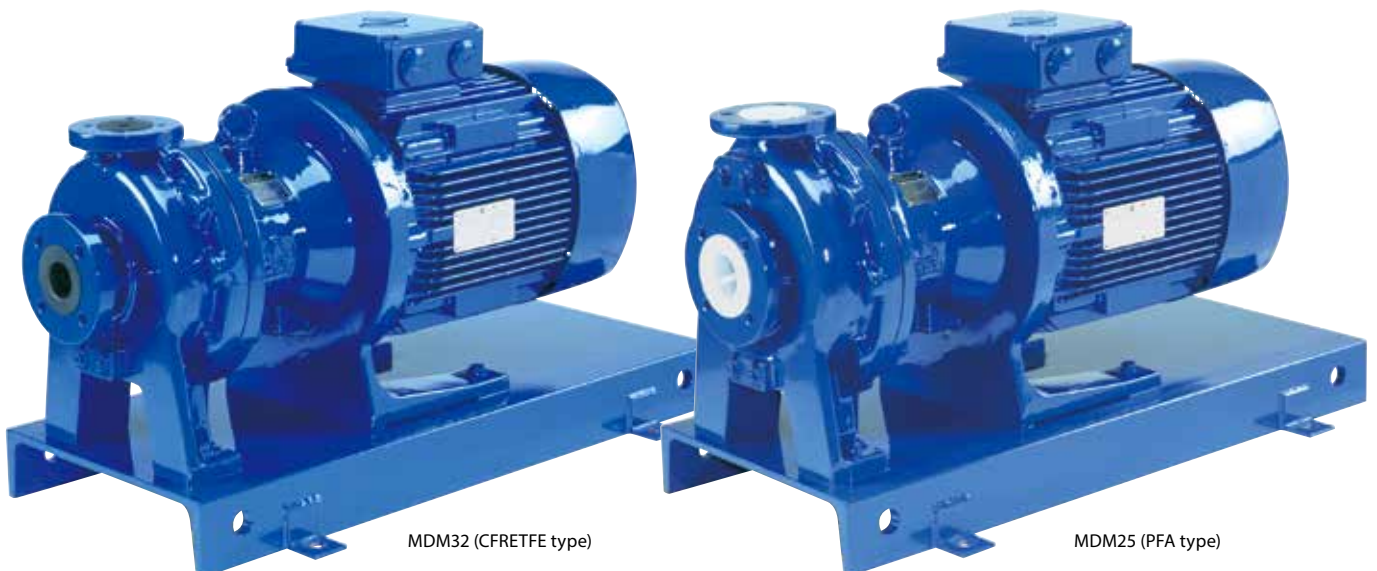
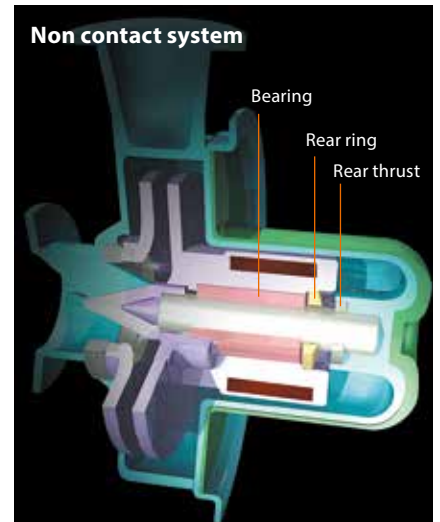

ETFE and PFA available in standard models

Carbon fibre reinforced CFRETFE and PFA linings can be supplied to meet many varying duties. PFA being a natural unfilled material generates fewer contaminants and makes it ideally suited for transfer of high purity chemicals.

Note: Long coupling type is only PFA version.

Highly durable structure

A ductile cast iron shell adds strength and durability to the outer peripheral surfaces of the fluororesin pump module. The rear casing which is placed under the highest stress is protected by a rear casing cover made from fibre reinforced plastic. This gives sufficient strength and eliminates the eddy current loss caused by the rotating magnetic field. Should it come into contact with the drive magnet unit, no spark would be generated and a high level of safety would be maintained.

Back pullout system

In order to facilitate inspection and maintenance, this series employs the back pullout system. This enables one to conduct inspections internally and replace parts without removing piping. The pump is designed to include safety measures that can prevent the liquid from leaking when the foot support (bracket) is pulled back.

Compliance with ISO standards (ISO2858/DIN EN22858)

The pump with a common base complies with ISO Standards in regard to piping connection.

Note 1: For compatibility in size with other series of our magnet pumps, please call us.

Note 2: ANSI and JIS standards are also available.

For details, please call us.

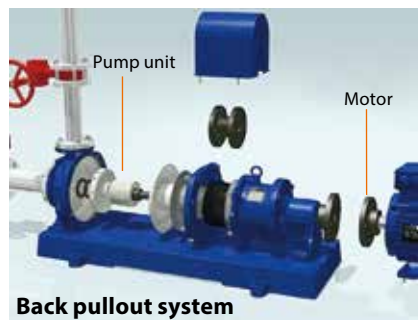

Back pullout system

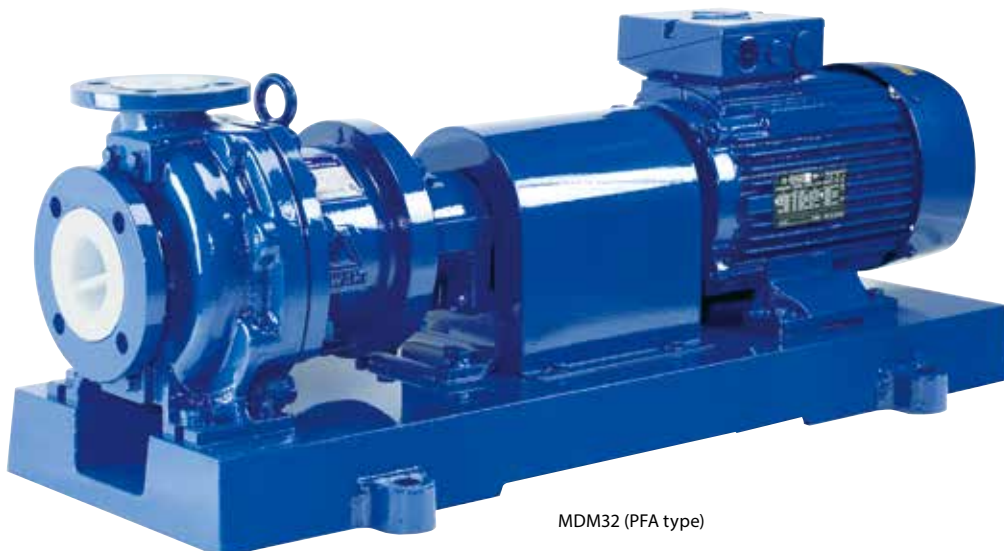

MDM32 (PFA type)

Construction

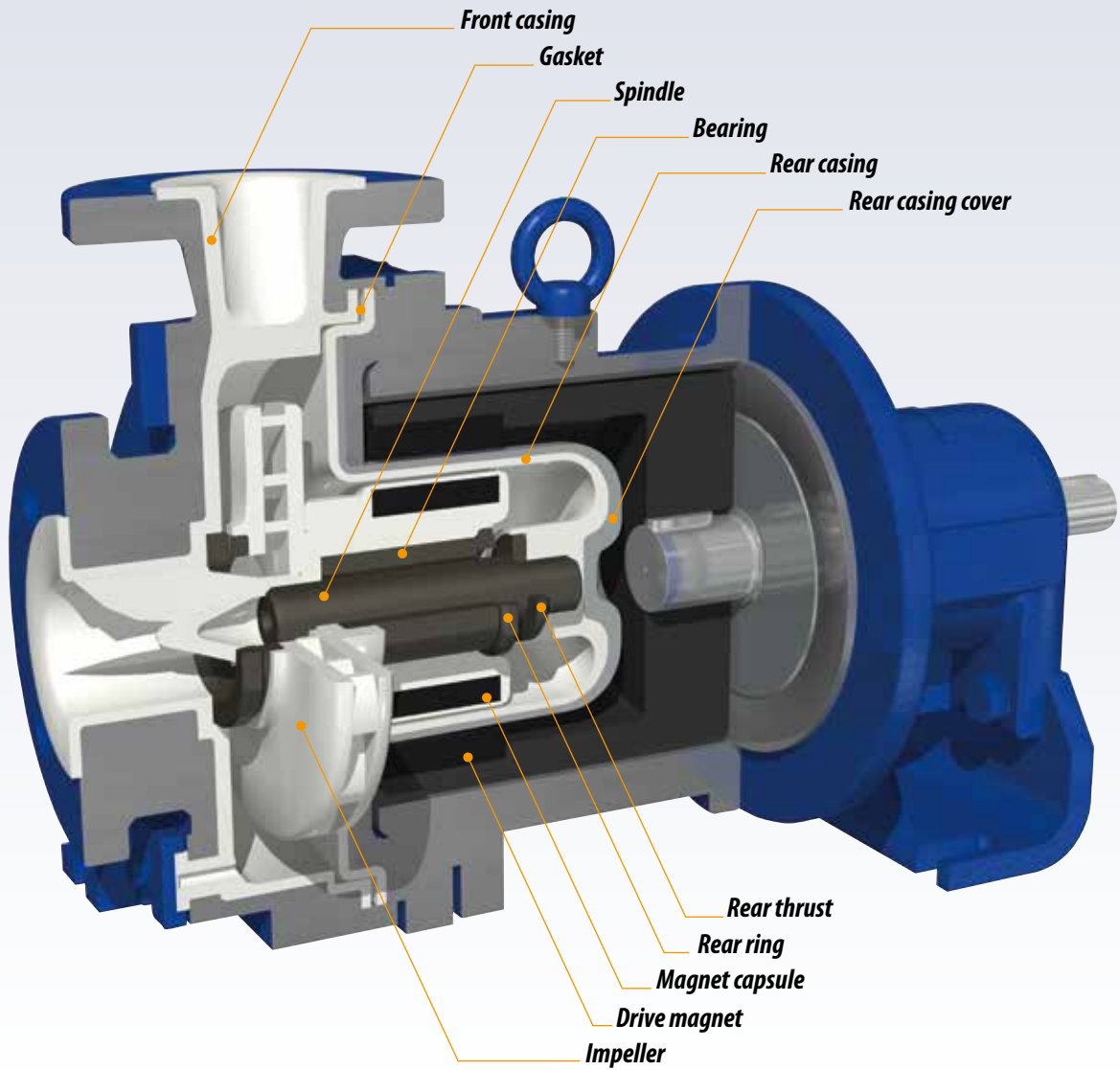

Wet-end materials

Materials	ECF	EKK	PKK/NKK
1 Front casing	CFRETFE	SIC	PFA
2 Rear casing ^(Note 1)			
3 Impeller			
4 Magnet capsule			
5 Bearing	High density carbon	SIC	SIC
6 Spindle	High purity alumina ceramic		
7 Liner ring	PTFE (with Filler)		
8 Mouth ring	High purity alumina ceramic		
9 Rear ring	PTFE (with filler)	PTFE	PTFE
10 Rear thrust	PTFE		
11 Gasket	PTFE		

Note 1: Rear casing support is used on MDM25-3 and MDM32-2 for applications over 80°C (PAT).

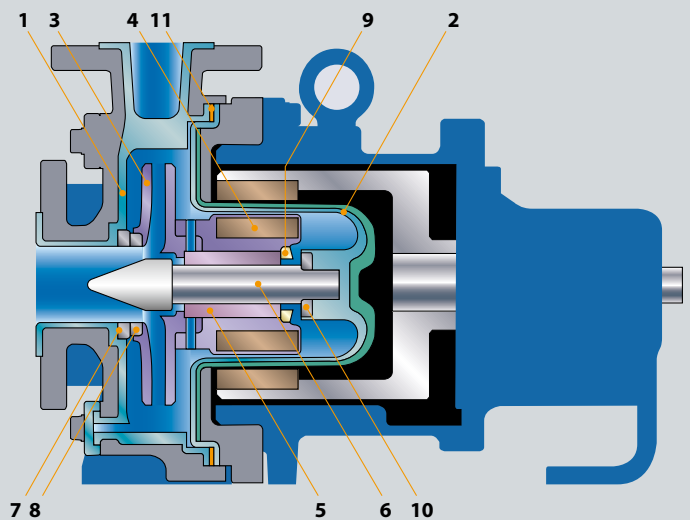

Front casing ETFE type

A moulding made of carbon fibre reinforced CFRETFE. It has both a high mechanical strength and excellent corrosion resistance. The outer peripheral surfaces are reinforced by a ductile cast iron outer casing in order to achieve excellent strength and durability.



CFRETFE type

Front casing PFA type

Natural PFA fluoro-resin is adapted as wetted parts. This construction is free from contamination and ideal for transfer of clean liquids or with less particle generation.



PFA type

Impeller

Closed type impellers are designed to give high efficiency. To ensure positive fixing of impeller to magnet capsule a spline system together with a pin fixing is employed. This prevents the impeller from moving axially off the magnet capsule (PAT.). MDM25 and 32 models now have impellers capable of reaching max. heads of 74 meters (50Hz) to widen the range of application.



CFRETFE type



PFA type

**Rear casing
Rear casing cover**

The fluoro-resin rear casing is strengthened by the outer rear casing cover which is manufactured in fibre reinforced plastic capable of withstanding a pressure of 1 MPa. (Note: For long coupling type, maximum pressure is 1.6MPa.)

This structure also eliminates any eddy current losses due to a rotating magnetic field. It also prevents sparks from being produced should the rear casing come into contact with the drive magnet unit.

A newly developed triple-layer casing (PAT.) is used for the high head models MDM25-3 and 32-2 when liquid temperature exceeds 80°C. This new design allows a rated 1.6MPa casing pressure overall temperature range. Since the front and rear casings are bolted together from the front casing side liquid does not leak out when the foot support (bracket) is pulled back.



PFA type with rear casing cover

Rear ring

To protect the pump against abnormal operation, such as cavitation or entrained air, where the magnet capsule experiences reverse axial thrust, a rear ring and rear thrust ring are used. The rear ring is designed to minimize heat generation compared to conventional designs. This prevents surrounding fluoro-resin from melting. (PAT.)

Rear Thrust

The rear thrust withstands axial loads encountered from abnormal operation, it also minimizes heat generation.

Magnet capsule

High strength rare earth magnets are totally encapsulated with fluoro-resin mouldings. Magnets are small and lightweight which increases the efficiency of the pump. Taking advantage of the high magnetic strength its new design of "Non contact system"(PAT.) was developed to protect pump from dry running. This enables us to offer pumps that will withstand dry running operation. (CF type only)



CFRETFE type



PFA type

Spindle

Both ends of the spindle are supported by the front casing and the rear casing (the fixed spindle type). There are two types of spindle; one is made of high purity alumina ceramic and the other made of SiC.



SiC type High purity alumina ceramic type

Bearing

Two standard bearing materials are available. SiC gives high resistance to abrasion. High density carbon withstands dry running operation. Bearings can be individually replaced.



SiC type High density carbon type

Gasket

A PTFE shrouded gasket is used to enhance sealing performance and corrosion resistance.

Specifications

2 pole motor type

50Hz

Model	Pump size Suction X Discharge	Impeller size	Capacity L/min	Head m	Motor kW
MDM25-1 (Impeller range 1)	40mm X 25mm	165	100	35.5	1.5 or 2.2
		160		33.5	
		150		29.0	
		140		25.0	
		130		20.5	
MDM25-2 (Impeller range 2)	40mm X 25mm	195	100	50.5	4.0, 5.5 or 7.5
		190		49.0	
		180		44.5	
		170		38.0	
		160		34.5	
MDM25-3 (Impeller range 3)	40mm X 25mm	225	100	74.0	5.5, 7.5, 11 or 15
		220		69.0	
		210		61.0	
		200		55.0	
		190		48.5	
MDM32-1 (Impeller range 1)	50mm X 32mm	165	208	35.0	4.0, 5.5 or 7.5
		160		32.5 Note1	
		150		28.5	
		140		25.0	
		130		20.5	
MDM32-2 (Impeller range 2)	50mm X 32mm	120	208	17.0	5.5, 7.5, 11 or 15
		225		70.0	
		220		67.5	
		210		60.0	
		200		54.0	
MDM40-1	65mm X 40mm	190	417	47.0	4.0, 5.5 or 7.5
		180		41.5	
		170		38.0	
		160		32.0	
		165		33.0	
MDM50-1	80mm X 50mm	160	833	31.0 Note2	5.5, 7.5, 11, 15
		150		27.0	
		140		22.5	
		130		18.0	
		120		12.0	

Note1: For long coupling type, head is 34.5m.

Note2: For long coupling type, head is 32.5m.

4 pole motor type

50Hz

Model	Pump size Suction X Discharge	Impeller size	Capacity L/min	Head m	Motor kW
MDM25-2 (Impeller range 2)	40 mm X 25 mm	200	50	12.0	1.5, 2.2, 4.0
MDM25-3 (Impeller range 3)	40 mm X 25 mm	225	50	15.0	1.5, 2.2, 4.0, 5.5
MDM32-1 (Impeller range 1)	50 mm X 32 mm	170	200	7.5	1.5, 2.2, 4.0
MDM32-2 (Impeller range 2)	50 mm X 32 mm	225	200	15.0	1.5, 2.2, 4.0, 5.5
MDM40-1	65 mm X 40 mm	170	300	7.0	1.5, 2.2, 4.0
MDM50-1	80 mm X 50 mm	170	500	8.0	1.5, 2.2, 4.0, 5.5

Common Specifications

• Temperature range of liquid handled	EKK/ECF: -20 to 105°C, PKK: -20 to 150°C, NKK: -20 to 120°C Note1	• Allowable maximum pressure	1.0 MPa (All long coupling type, MDM25-3 and MDM32-2 are 1.6MPa.)
• Allowable slurry (KK type only)	Please contact us.	• Standard color of paint	Ultra marine blue RAL5002

Note1: Please contact us when handling liquid temperature is outside range of 0°C to 120°C.
Should your requirement be beyond the specs. shown in this catalog, please contact your nearest Iwaki distributor.

Pump identification

MDM 40 - 150 1 E KK F 075 I - D 2 H

- Pump size (Suction X Discharge)**
 25: 40mm X 25mm
 32: 50mm X 32mm
 40: 65mm X 40mm
 50: 80mm X 50mm
- Wet-end main material**
 E: CFRETFE
 P: PFA
 N: PFA(MDM25-2, 32-1)
- Type of motor**
 C: Long coupling type
 F: Flange motor
- Impeller size**
 100mm to 225mm
- Impeller range**
 1, 2, 3
- Material of Bearing / Spindle**
 KK: SiC/SiC
 CF: High density carbon/
 High purity alumina ceramic
- Motor output**
 015: 1.5kW 022: 2.2kW 040: 4.0kW 055: 5.5kW
 075: 7.5kW(2P) 110: 11kW(2P) 150: 15kW(2P)
- Special code**
 H: 80 to 120°C
 (Applicable model: Flange motor type:
 MDM25-3, MDM32-2 All sizes of long coupling type)
 T: 120 to 150°C
- Special version**
 A: Without drain + With base
 S: Without drain + With base + Special version
 D: With drain + With base
 X: With drain + With base + Special version
 B: Without drain + Without base
 Y: Without drain + Without base + Special version
 E: With drain + Without base
 Z: With drain + Without base + Special version
- Standard for pipe connection and motor**
 I: ISO flange + IEC motor J: JIS flange + JIS motor
- Motor pole**
 2: 2 pole 4: 4 pole

Note: Long coupling type is designed for 50 cycle area.

Performance curves

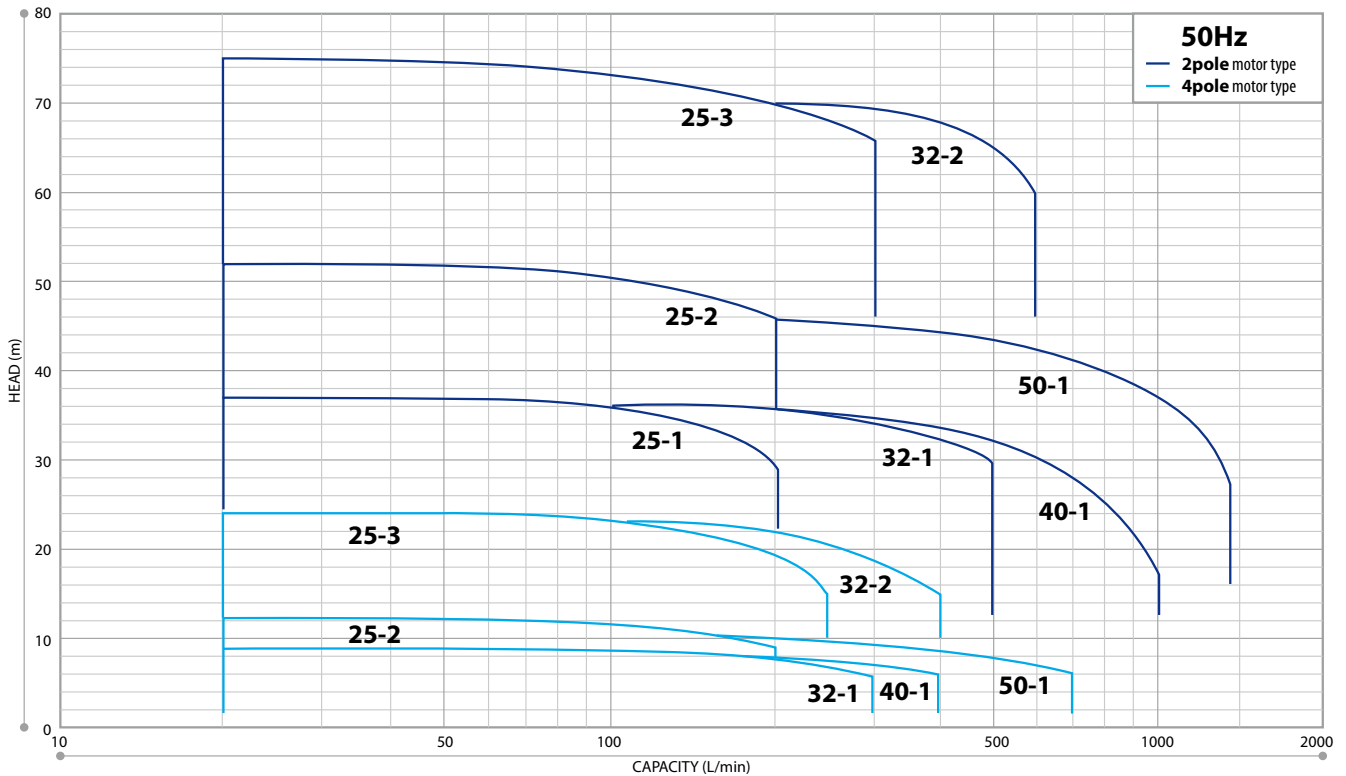

Optional accessories

Iwaki pump protector DRN series

Detects unusual pump operating conditions including dry-running and overload

The DRN model protects equipment (including pumps) from damage!
 Minimizes production downtime.
 Identifies possible causes of alarms so they can be investigated and addressed.



- Multiple Input: Two analog, one digital, one temperature input and one current input
- Easy operation: Equipped with EASY setup mode to remember the operation status and set the lower/upper limit values, as well as AUTO setup mode
- Bar graph: Visible indication of current operating status
- Logging capability: Data log feature for preventative maintenance scheduling
- Communication: RS485 external communication capability

Specifications

Model	DRN-01	DRN-02
Amperometric range	0.5-30.00A	5.0-200.0A
Unit's source voltage	AC100-240V 50/60Hz 10VA	
Operating temperature	0-40°C	
Operating humidity	35-85%RH	

Dimensions

2 pole motor type

Flange motor type
(with base type)

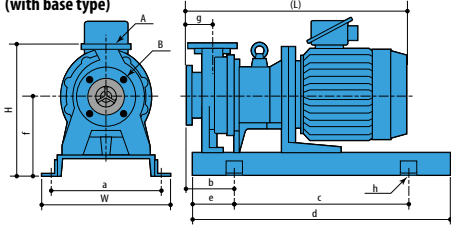

Flange motor type
(without base type)

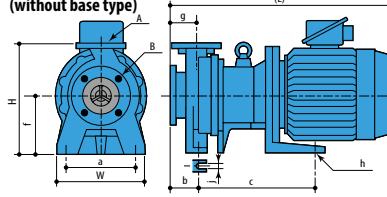

Long coupling type

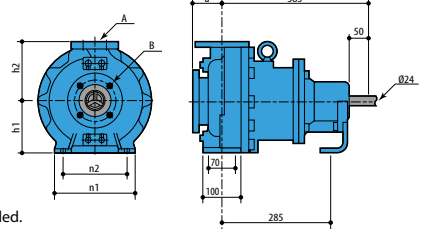

Note: The dimensions may differ with the type of motor installed.

Flange motor type with base

Model	Motor kW	(W)	(H)	(L)	a	b	c	d	e	f	g	h	A	B	Mass kg Less motor
MDM25-1	1.5	400	400	513	350	135	480	710	115	240	80	4×ø19	25	40	63
	2.2			542											
	4.0			625											
MDM25-2	5.5	400	430	689	350	150	540	800	130	250	80	4×ø19	25	40	89
	7.5			689											92
	11			689											92
MDM25-3	5.5	400	415	711	350	172	540	800	130	250	102	4×ø19	25	40	100
	7.5			874											135
	15			874											135
MDM32-1	4.0	400	410	625	350	150	540	800	130	250	80	4×ø19	32	50	84
	5.5			689											87
	7.5			689											87
MDM32-2	5.5	400	430	689	350	150	540	800	130	250	80	4×ø19	32	50	105
	7.5			852											140
	11			852											140
MDM40-1	4.0	400	410	625	350	150	540	800	130	250	80	4×ø19	40	65	85
	5.5			689											88
	7.5			689											88
MDM50-1	5.5	400	430	709	350	170	540	800	130	250	100	4×ø19	50	80	96
	7.5			872											129
	11			872											129

Flange motor type without base

Model	Motor kW	(W)	(H)	(L)	a	b	c	f	g	h	j	A	B	Mass kg Less motor
MDM25-1	1.5	180	310	513	130	100	150	150	80	2×ø15	15	25	40	37
	2.2			542										
	4.0			625										
MDM25-2	5.5	280	360	689	220	90	285	180	80	2×ø14	14	25	40	62
	7.5			365			65							
	11			365			65							
MDM25-3	5.5	280	345	711	220	112	365	180	102	2×ø14	14	25	40	70
	7.5			874			85							
	15			874			85							
MDM32-1	4.0	280	340	625	220	90	285	180	80	2×ø14	14	32	50	57
	5.5			689			60							
	7.5			689			60							
MDM32-2	5.5	280	360	689	220	90	365	180	80	2×ø14	14	32	50	75
	7.5			852			90							
	11			852			90							
MDM40-1	4.0	280	340	625	220	90	285	180	80	2×ø14	14	40	65	58
	5.5			689			61							
	7.5			689			61							
MDM50-1	5.5	280	360	709	220	110	365	180	100	2×ø14	14	50	80	69
	7.5			872			82							
	11			872			82							

Long coupling type without base, coupling, motor

Model	a	h1	h2	n1	n2	A	B	Mass kg Less motor
MDM32-1601	80	132	160	240	190	32	50	70
MDM32-2002		160	180					80
MDM40-1601		132	160					70
MDM50-1601	100	160	180	265	212	50	80	80

IWAKI CO., LTD. 6-6 Kanda-Sudacho 2-chome Chiyoda-ku Tokyo 101-8558 Japan TEL : (81)3 3254 2935 FAX : 3 3252 8892 IWAKI has global net work. Please find your distributor location at www.iwakupumps.jp

- | | | | |
|--|--|--|--|
| European office : IWAKI Europe GmbH
Germany : IWAKI Europe GmbH
Holland : IWAKI Europe GmbH (Netherlands Branch)
Italy : IWAKI Europe GmbH (Italy Branch)
Spain : IWAKI Europe GmbH (Spain Branch)
Belgium : IWAKI Belgium N.V.
Denmark : IWAKI Nordic A/S
Finland : IWAKI Suomi Oy
France : IWAKI France S.A.
Norway : IWAKI Norge AS
Sweden : IWAKI Sverige AB
U.K. : IWAKI Pumps (UK) Ltd. | TEL: (49)2154 9254 0 FAX: 2154 9254 48
TEL: (49)2154 9254 50 FAX: 2154 9254 55
TEL: (31)74 2420011 FAX: (49)2154 925448
TEL: (39)0444 371115 FAX: 0444 335350
TEL: (34)93 37 70 198 FAX: 93 47 40 991
TEL: (32)13 67 02 00 FAX: 13 67 20 30
TEL: (45)48 24 2345 FAX: 48 24 2346
TEL: (358)9 2745810 FAX: 9 2742715
TEL: (33)1 69 63 33 70 FAX: 1 64 49 92 73
TEL: (47)23 38 49 00 FAX: 23 38 49 01
TEL: (46)8 511 72900 FAX: 8 511 72922
TEL: (44)1743 231363 FAX: 1743 366507
() Country codes | U.S.A. : IWAKI America Inc.
Argentina : IWAKI America Inc. (Argentina Branch)
Brazil : IWAKI Do Brasil Comercio De Bombas Hidraulicas LTDA.
Singapore : IWAKI Singapore Pte Ltd.
Indonesia : IWAKI Singapore (Indonesia Office)
Malaysia : IWAKI Sdn. Bhd.
Australia : IWAKI Pumps Australia Pty Ltd.
Hong Kong : IWAKI Pumps Co., Ltd.
China : GFTZ IWAKI Engineering & Trading Co., Ltd.
Korea : IWAKI Korea Co., Ltd.
Taiwan : IWAKI Pumps Taiwan Co., Ltd.
Thailand : IWAKI (Thailand) Co., Ltd.
Vietnam : IWAKI Pumps Vietnam Co., Ltd. | TEL: (1)508 429 1440 FAX: 508 429 1386
TEL: (54)11 4745 4116 FAX: 19 3244 5900
TEL: (55)19 3244 5900 FAX: 6316 3221
TEL: (65)6316 2028 FAX: 21 6906612
TEL: (60)3 7803 8807 FAX: 3 7803 4800
TEL: (61)2 9899 2411 FAX: 2 9899 2421
TEL: (852)2607 1168 FAX: 2607 1000
TEL: (86)20 84350603 FAX: 20 84359181
TEL: (86)21 6272 7502 FAX: 21 6272 6929
TEL: (82)2 2630 4800 FAX: 2 2630 4801
TEL: (886)2 8227 6900 FAX: 2 8227 6818
TEL: (66)2 322 2471 FAX: 2 322 2477
TEL: (84)613 933456 FAX: 613 933399 |
|--|--|--|--|

Caution for safety use: Before use of pump, read instruction manual carefully to use the product correctly. Actual pumps may differ from the photos. Specifications and dimensions are subject to change without prior notice. For further details please contact us.

Legal attention related to export. Our products and/or parts of products fall in the category of goods contained in control list of international regime for export control. Please be reminded that export license could be required when products are exported due to export control regulations of countries. The posting and copying from this catalogue without permission is not accepted firmly.