

MDM 32-1-ECFF•EKKF (ETFE)

No. 60-146
Sep. 01, 2016

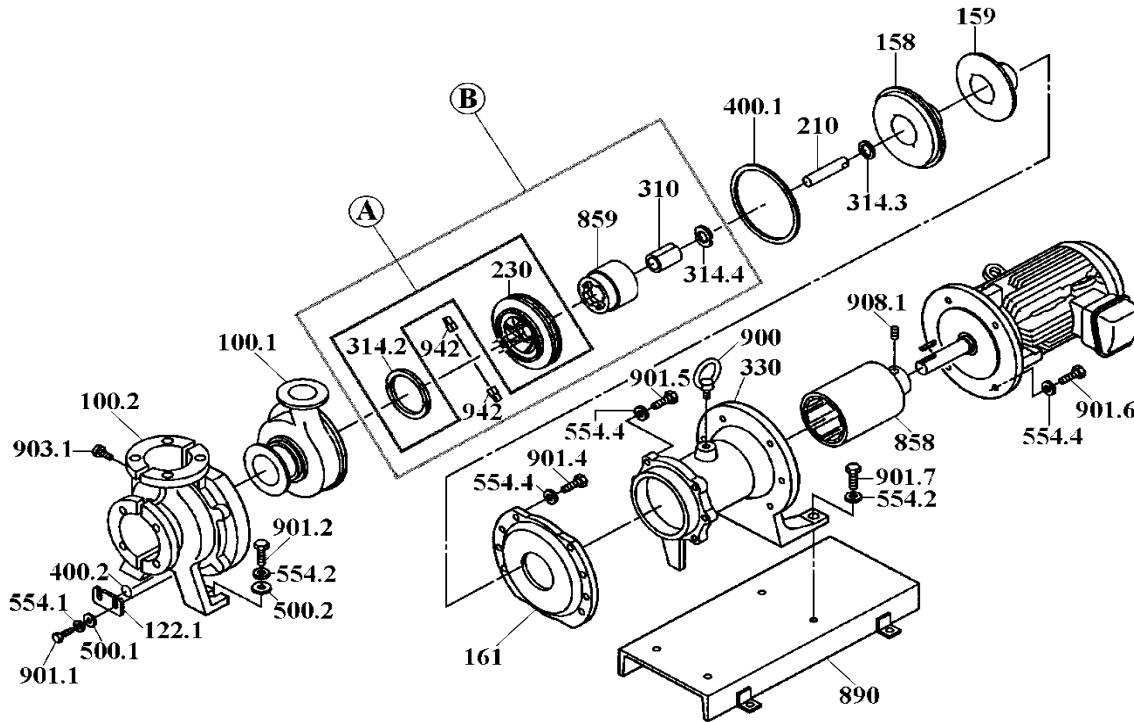

Item	Description	Q'ty	Remarks		MDM32-1-ECFF		MDM32-1-EKKF		
			ECFF	EKKF	Part No.	Code No.	Part No.	Code No.	
100.1	Front Casing (D•E) with Drain Hole	1	CFRETFE+CE		MDM0204	1230901710			
		1	CFRETFE+SiC				MDM0203	1230901720	
	Front Casing (A•B) without Drain Hole	1	CFRETFE+CE		MDM0206	1231224810			
		1	CFRETFE+SiC				MDM0205	1231224820	
100.2	*Cover Unit (ISO)	1	Ductile Iron		MDM0505	1210051000	↔	↔	
158	Rear Casing	1	CFRETFE		MDM0211	1220261800	↔	↔	
230	Impeller [E32/40] CFRETFE	50Hz	165	1	Ø 165 mm	MDM0239	1230899710	↔	↔
			160	1	Ø 160 mm	MDM0240	1230899720	↔	↔
			150	1	Ø 150 mm	MDM0241	1230899730	↔	↔
		60Hz	145	1	Ø 145 mm	MDM0242	1230899740	↔	↔
			140	1	Ø 140 mm	MDM0243	1230899750	↔	↔
		50•60Hz	130	1	Ø 130 mm	MDM0244	1230899760	↔	↔
			120	1	Ø 120 mm	MDM0245	1230899770	↔	↔
60Hz	110	1	Ø 110 mm	MDM0246	1230899780	↔	↔		
314.2	Mouth Ring	1	PTFE	SiC	MDM0019	1240687000	MDM0018	1240684600	
A	Impeller+Mouth Ring Assembly [E32/40] (230+314.2)	165	1	Ø 165 mm	MDM0263	1230900610	MDM0247	1230900710	
		160	1	Ø 160 mm	MDM0264	1230900620	MDM0248	1230900720	
		150	1	Ø 150 mm	MDM0265	1230900630	MDM0249	1230900730	
		145	1	Ø 145 mm	MDM0266	1230900640	MDM0250	1230900740	
		140	1	Ø 140 mm	MDM0267	1230900650	MDM0251	1230900750	
		130	1	Ø 130 mm	MDM0268	1230900660	MDM0252	1230900760	
		120	1	Ø 120 mm	MDM0269	1230900670	MDM0253	1230900770	
		110	1	Ø 110 mm	MDM0270	1230900680	MDM0254	1230900780	
210	Spindle	1	CE	SiC	MDM0122	1240680100	MDM0121	1240680200	
310	Bearing	1	Carbon	SiC	MDM0124	1240682400	MDM0123	1240680900	
314.3	Rear Thrust Ring	1	PTFE		MDM0125	1240681100	↔	↔	
314.4	Rear Ring	1	CE	SiC	MDM0127	1240680700	MDM0126	1240680800	
859	Magnet Capsule	4,0•5,5 kW [7]	1	CFRETFE+Mg.	MDM0134	1230894410	↔	↔	
		7,5 kW [10]	1	CFRETFE+Mg.	MDM0288	1230894420	↔	↔	
B	Impeller+Magnet Capsule Ass'y (230+310+314.2+ 314.4+859+942)	165	1	4,0•5,5 kW	MDM0271	2270132610	MDM0255	2270132710	
		110~160	1	4,0•5,5 kW	<Specify impeller size.>		<Specify impeller size.>		
		165	1	7,5 kW	MDM0596	2270140210	MDM0588	2270140310	
		110~160	1	7,5 kW	<Specify impeller size.>		<Specify impeller size.>		

*Note: "Cover Unit" is furnished with 5 x Cap Bolt (903.1).

△ Subject to change without prior notice! △ Actual pump may differ from the exploded view!

MDM 32-1•40-1-E•P•N (ETFE•PFA)

No. 60-147c
Sep. 01, 2016

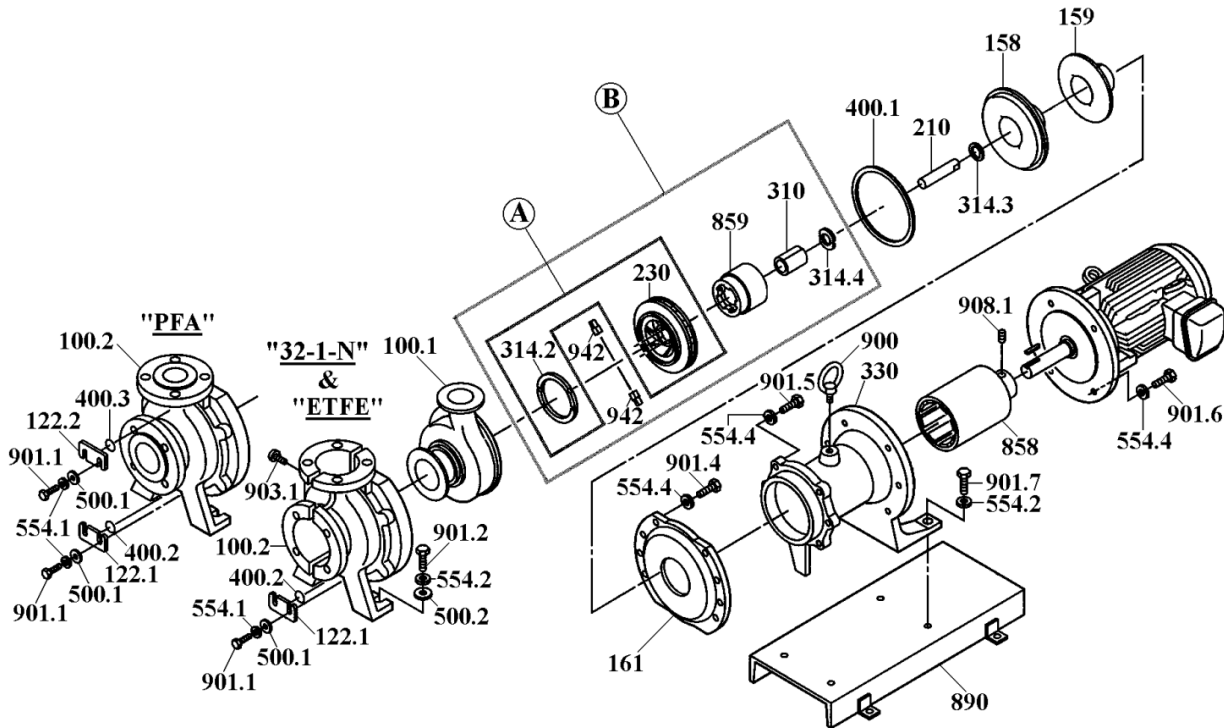

Item	Description	Quantity		Material	Part No.	Code No.		
		32-N	PFA					
122.1	Drain Plate	1	1	Steel	MDM0009	1240485700		
122.2	Air Vent Plate		1	Steel	MDM0009	1240485700		
159	Rear Casing Cover	1	1	FRP	MDM0212	1220262300		
161	Rear Casing Support	1	1	Ductile Iron	MDM0213	1220260200		
330	Foot Support	4,0 kW (IEC112)	1	1	Ductile Iron	MDM0128	1220260400	
		5,5•7,5 kW (IEC132)	1	1	Ductile Iron	MDM0129	1220260500	
400.1	Gasket	1	1	PTFE	MDM0214	1230889500		
400.2	Drain Gasket		D•E	1	1	PTFE	MDM0025	1240485900
400.3	Air Vent Gasket		D•E		1	PTFE	MDM0025	1240485900
*858	Drive Magnet Unit <*See note>	4,0 kW [DJ5]	1	1	Steel+R.E.Mag.	MDM0131	1220278700	
		5,5 kW [DJ7]	1	1	Steel+R.E.Mag.	MDM0132	1220280020	
		7,5 kW [DJ10]	1	1	Steel+R.E.Mag.	MDM0286	1220280030	
890	Base Plate		A•D	1	1	Steel	MDM0135	1230891800
900	Eye Bolt (M12)	1	1	Steel	MDM0036	0150800003		
942	Impeller Pin	2	2	PFA	MDM0138	1240681900		
*500.1	Plate Washer (Drain•Air Vent Plate) M8	2	4	A4 (SUS316 eq.)	MDM0026	0153500074		
*500.2	Plate Washer (Base) M12		A•D	2	2	A4 (SUS316 eq.)	MDM0027	0153500029
*554.1	Spring Washer (Drain•Air Vent Plate) M8	2	4	A4 (SUS316 eq.)	MDM0028	0154100057		
*554.2	Spring Washer (Base) M12		A•D	4	4	A4 (SUS316 eq.)	MDM0029	0154100024
*554.4	" " (Cover•Rear C.Support•Motor) M12	16	16	A4 (SUS316 eq.)	MDM0029	0154100024		
*901.1	Hex. Bolt (Drain•Air Vent Plate) M8x20	2	4	A4 (SUS316 eq.)	MDM0037	0150100163		
*901.2	Hex. Bolt (Base) M12x40		A•D	2	2	A4 (SUS316 eq.)	MDM0555	0150100208
*901.4	Hex. Bolt (Cover) M12x45	8	8	A4 (SUS316 eq.)	MDM0137	0150100209		
*901.5	Hex. Bolt (Rear Casing Support) M12x35	4	4	A4 (SUS316 eq.)	MDM0136	0150100207		
*901.6	Hex. Bolt (Motor)	4,0 kW	M12x40	4	4	A4 (SUS316 eq.)	MDM0555	0150100208
		5,5•7,5 kW	M12x45	4	4	A4 (SUS316 eq.)	MDM0137	0150100209
*901.7	Hex. Bolt (Base) M12x40		A•D	2	2	A4 (SUS316 eq.)	MDM0555	0150100208
**903.1	Cap Bolt (Cover) M6x20	5		A4 (SUS316 eq.)	MDM0043	0150300093		
908.1	Setscrew (Drive Magnet Unit) M8x10	2	2	Steel	MDM0044	0152100046		

*Note: "Drive Magnet Unit" is furnished with 2 x Setscrew (908.1).

⚠ Subject to change without prior notice! ⚠ Actual pump may differ from the exploded view!