

MDM 32-1-PKK•NKK-F (PFA)

No. 60-148
Sep. 01, 2016

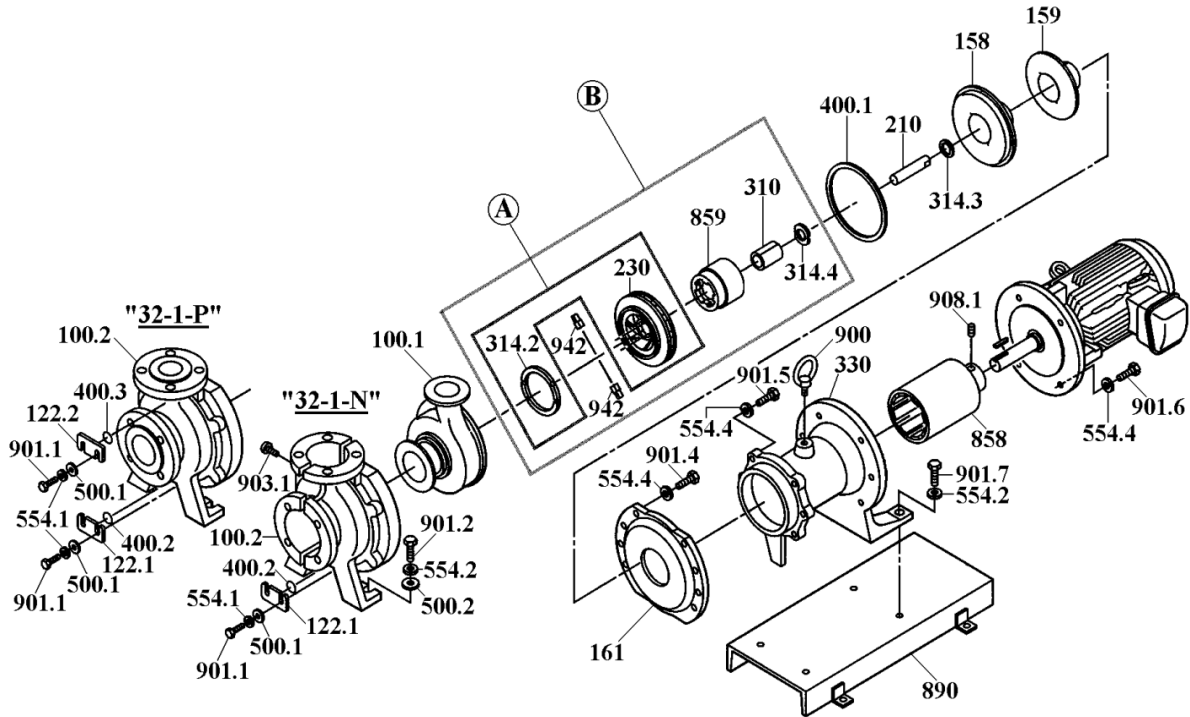

Item	Description		Q'ty	Material	Part No.	Code No.		
* 100.1	Front Casing with Drain Hole		1	PFA+SiC	MDM1101	1231253600		
* 100.1	Front Casing without " "		1	PFA+SiC	MDM1102	1210048600		
* 100.2	*Cover Unit (ISO)		1	Ductile Iron	MDM1104	1210048800		
** 100.2	Front Casing Unit (ISO)	with Air/Drain Holes	1	PFA+SiC+FCD	MDM0503	1230901420		
** 100.2		without " "	1	PFA+SiC+FCD	MDM0504	1230901440		
158	Rear Casing		1	PFA	MDM0210	1220263100		
230	Impeller [P32/40]	50Hz	165	Ø 165 mm	1	PFA	MDM0215	1230899910
			160	Ø 160 mm	1	PFA	MDM0216	1230899920
			150	Ø 150 mm	1	PFA	MDM0217	1230899930
		60Hz	145	Ø 145 mm	1	PFA	MDM0218	1230899940
			140	Ø 140 mm	1	PFA	MDM0219	1230899950
		50•60Hz	130	Ø 130 mm	1	PFA	MDM0220	1230899960
			120	Ø 120 mm	1	PFA	MDM0221	1230899970
60Hz	110	Ø 110 mm	1	PFA	MDM0222	1230899980		
314.2	Mouth Ring		1	SiC	MDM0018	1240684600		
A	Impeller+Mouth Ring Assembly [P32/40] (230+314.2)	165	Ø 165 mm	1	PFA+SiC	MDM0223	1230900810	
		160	Ø 160 mm	1	PFA+SiC	MDM0224	1230900820	
		150	Ø 150 mm	1	PFA+SiC	MDM0225	1230900830	
		145	Ø 145 mm	1	PFA+SiC	MDM0226	1230900840	
		140	Ø 140 mm	1	PFA+SiC	MDM0227	1230900850	
		130	Ø 130 mm	1	PFA+SiC	MDM0228	1230900860	
		120	Ø 120 mm	1	PFA+SiC	MDM0229	1230900870	
110	Ø 110 mm	1	PFA+SiC	MDM0230	1230900880			
210	Spindle		1	SiC	MDM0121	1240680200		
310	Bearing		1	SiC	MDM0123	1240680900		
314.3	Rear Thrust Ring		1	PTFE (Natural)	MDM0614	1240690700		
314.4	Rear Ring		1	SiC	MDM0126	1240680800		
859	Magnet Capsule Unit	4,0•5,5 kW [P7]	1	PFA+R.E.Mag.	MDM0133	1230897010		
		7,5 kW [P10]	1	PFA+R.E.Mag.	MDM0287	1230897020		
B	Impeller+Magnet Capsule Assembly (230+310+314.2+314.4+859+942)	165	4,0•5,5 kW	1	PFA+SiC+Mag.	MDM0231	2270132810	
		110~160	4,0•5,5 kW	1	PFA+SiC+Mag.	<Specify impeller size.>		
		165	7,5 kW	1	PFA+SiC+Mag.	MDM0580	2270140410	
		110~160	7,5 kW	1	PFA+SiC+Mag.	<Specify impeller size.>		

*Note: "Cover Unit" for 'NKK' is furnished with 5 x Cap Bolt (903.1).

△ Subject to change without prior notice! △ Actual pump may differ from the exploded view!

MDM 32-1•40-1-E•P•N (ETFE•PFA)

No. 60-147c
Sep. 01, 2016

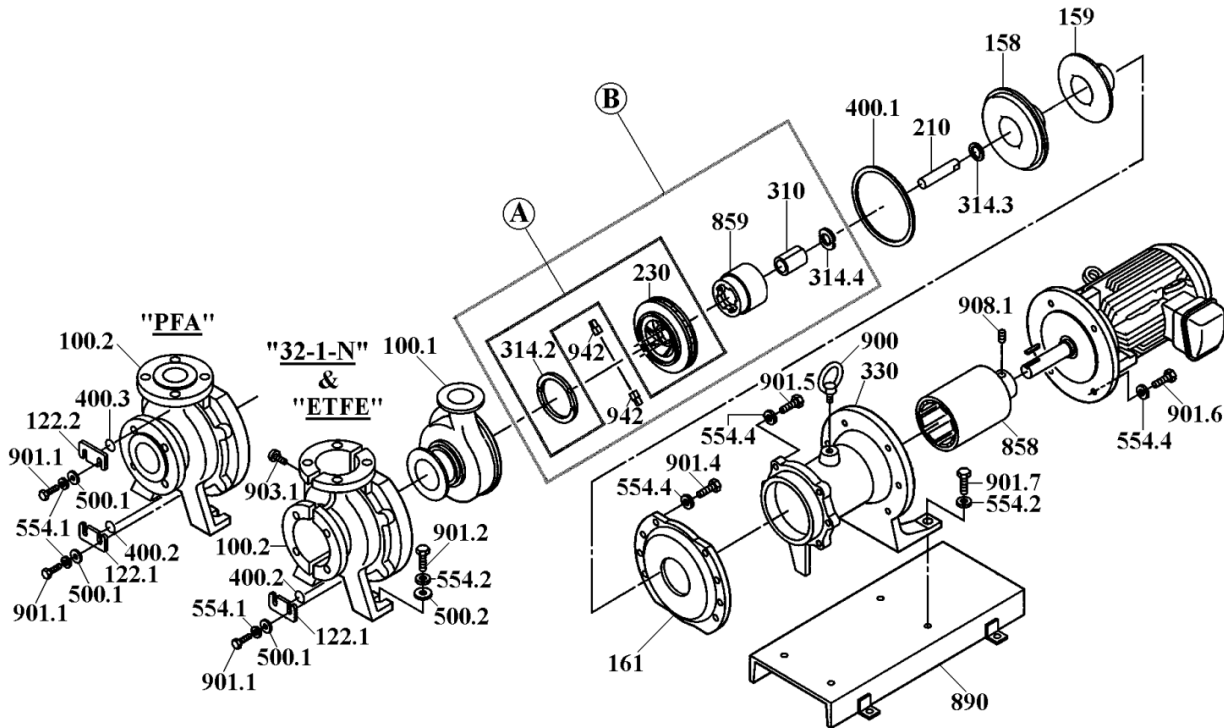

Item	Description	Quantity		Material	Part No.	Code No.		
		32-N	PFA					
122.1	Drain Plate	1	1	Steel	MDM0009	1240485700		
122.2	Air Vent Plate		1	Steel	MDM0009	1240485700		
159	Rear Casing Cover	1	1	FRP	MDM0212	1220262300		
161	Rear Casing Support	1	1	Ductile Iron	MDM0213	1220260200		
330	Foot Support	4,0 kW (IEC112)	1	1	Ductile Iron	MDM0128	1220260400	
		5,5•7,5 kW (IEC132)	1	1	Ductile Iron	MDM0129	1220260500	
400.1	Gasket	1	1	PTFE	MDM0214	1230889500		
400.2	Drain Gasket		D•E	1	1	PTFE	MDM0025	1240485900
400.3	Air Vent Gasket		D•E	1	1	PTFE	MDM0025	1240485900
*858	Drive Magnet Unit <*See note>	4,0 kW [DJ5]	1	1	Steel+R.E.Mag.	MDM0131	1220278700	
		5,5 kW [DJ7]	1	1	Steel+R.E.Mag.	MDM0132	1220280020	
		7,5 kW [DJ10]	1	1	Steel+R.E.Mag.	MDM0286	1220280030	
890	Base Plate		A•D	1	1	Steel	MDM0135	1230891800
900	Eye Bolt (M12)	1	1	Steel	MDM0036	0150800003		
942	Impeller Pin	2	2	PFA	MDM0138	1240681900		
*500.1	Plate Washer (Drain•Air Vent Plate) M8	2	4	A4 (SUS316 eq.)	MDM0026	0153500074		
*500.2	Plate Washer (Base) M12		A•D	2	2	A4 (SUS316 eq.)	MDM0027	0153500029
*554.1	Spring Washer (Drain•Air Vent Plate) M8	2	4	A4 (SUS316 eq.)	MDM0028	0154100057		
*554.2	Spring Washer (Base) M12		A•D	4	4	A4 (SUS316 eq.)	MDM0029	0154100024
*554.4	" " (Cover•Rear C.Support•Motor) M12	16	16	A4 (SUS316 eq.)	MDM0029	0154100024		
*901.1	Hex. Bolt (Drain•Air Vent Plate) M8x20	2	4	A4 (SUS316 eq.)	MDM0037	0150100163		
*901.2	Hex. Bolt (Base) M12x40		A•D	2	2	A4 (SUS316 eq.)	MDM0555	0150100208
*901.4	Hex. Bolt (Cover) M12x45	8	8	A4 (SUS316 eq.)	MDM0137	0150100209		
*901.5	Hex. Bolt (Rear Casing Support) M12x35	4	4	A4 (SUS316 eq.)	MDM0136	0150100207		
*901.6	Hex. Bolt (Motor)	4,0 kW	M12x40	4	4	A4 (SUS316 eq.)	MDM0555	0150100208
		5,5•7,5 kW	M12x45	4	4	A4 (SUS316 eq.)	MDM0137	0150100209
*901.7	Hex. Bolt (Base) M12x40		A•D	2	2	A4 (SUS316 eq.)	MDM0555	0150100208
**903.1	Cap Bolt (Cover) M6x20	5		A4 (SUS316 eq.)	MDM0043	0150300093		
908.1	Setscrew (Drive Magnet Unit) M8x10	2	2	Steel	MDM0044	0152100046		

*Note: "Drive Magnet Unit" is furnished with 2 x Setscrew (908.1).

⚠ Subject to change without prior notice! ⚠ Actual pump may differ from the exploded view!